

**Balzano**<sup>®</sup>  
— 1908 Italy —

# NUTRI BLENDER 500W

## Instruction Manual



**Model: EK-3350**

## IMPORTANT SAFETY INSTRUCTIONS

WHEN USING ELECTRICAL APPLIANCES, BASIC SAFETY PRECAUTIONS SHOULD ALWAYS BE FOLLOWED, INCLUDING THE FOLLOWING:

Please read this entire manual before using this device, paying extra attention to these safety warnings and guidelines. Please keep this manual in a safe place for future reference.

### IMPORTANT

- Do not immerse the cord, plug or base in water or other liquids.
- Do not pull, twist or mistreat the power cord.
- Avoid contact with moving parts.
- The use of attachments or parts not recommended or sold by the manufacturer may cause fire, electric shock or injury and void any applicable warranty.
- Unplug the appliance when it is not in use. Make sure the machine is unplugged before assembling, disassembling, adding additional parts, and cleaning.
- Keep hands and utensils away from the cutting blade while chopping or blending food to reduce the risk of severe injury to person or damage to the blender/chopper. A scraper may be used, but only when the blender/food chopper is not running.
- NEVER KEEP THE BLADE RUNNING FOR MORE THAN ONE MINUTE AT A TIME, AS IT CAN CAUSE PERMANENT DAMAGE TO THE MOTOR. If the motor stops working, unplug the Power Base and let it cool for a few hours before attempting to use it again. Your appliance has an internal thermal breaker that shuts off the unit when it overheats. Letting the thermal breaker cool down should allow the Power Base to reset.
- Do not operate any appliance with a damaged cord or plug or if the appliance malfunctions, or is dropped or damaged in any manner. Contact Customer Service for assistance in obtaining a replacement.
- Unplug the appliance when it is not in use, before putting on or taking off parts, and before cleaning or assembling.
- Always use your appliance on a clean, flat, hard, dry surface.
- Always completely assemble the blade and cup before placing on the Power Base.
- Do not allow the cord to hang over the side of the counter or table.
- Do not allow cord to touch hot surfaces, including stove.
- Never leave the appliance unattended while it is in use.
- Never blend carbonated beverages. Released gases can cause pressure to build up and the container to burst, resulting in possible injury.
- Make sure the blade is securely screwed onto the Tall/Short Cup before placing it on the Power Base.
- Never run the appliance without food or liquid contents in any of the cups.
- Close supervision is necessary when any appliances are used by or near children.
- To reduce the risk of injury, never place the cutting blade on the Power Base without putting cup properly in place.

- Be certain that blade is completely and firmly screwed on to the cups before operating appliance.
- Do not use the appliance in the rain or in wet conditions.
- Do not use outdoors if exposed to inclement weather elements.
- Blades are sharp. Handle carefully.
- Do not attempt to defeat the cover interlock mechanism.
- Check gasket to make sure it is not damaged, and it is completely seated in the Cross Blade / Flat Blade unit before each use.
- Do not use appliance for other than intended use.
- Always use your appliance on a clean, flat, hard, dry surface, never on cloth or paper which may block the fan vents and cause overheating.
- Never Blend Hot Ingredients! Always allow ingredients to cool before blending. Heat and blending can cause vessel to pressurize and expel hot contents, resulting in possible injury.
- Always completely assemble the blade and cup before placing on Power Base; never insert or store the blade in base unless attached to a cup.
- Switch off the appliance and disconnect from supply before changing accessories or approaching parts that move in use.
- This appliance is not intended for use by persons (including children) with reduced physical, sensory or mental capabilities, or lack of experience and knowledge unless they have been given supervision or instruction concerning use of the appliance by a person responsible for their safety.
- If the supply cord is damaged, it must be replaced by the manufacturer, its service agent or similarly qualified persons in order to avoid a hazard.
- Children should be supervised to ensure that they do not play with the appliance.
- Be careful if hot liquid is poured into the blender as it can be ejected out of the appliance due to a sudden steaming.
- Always disconnect the appliance from the supply if it is left unattended and before assembling, disassembling or cleaning.
- Do not put the blades in the dishwasher. Simply hand wash with warm soapy water.
- When washing blades, do not attempt to remove the gasket ring. Simply hand wash the blades in warm soapy water. Attempted removal of the gasket may permanently damage the blade configuration and cause leakage. If in time a gasket becomes loose or damaged, please contact customer service for a replacement blade holder.

## **ELECTROMAGNETIC FIELDS (EMF)**

This appliance complies with all requirements relating to electromagnetic fields (EMF)

**SAVE THESE INSTRUCTIONS**

## INTRODUCTION

Thank you for purchasing this Balzano product! This compact little machine acts as a blender, food processor, and electric mixer in all in one. It's small, versatile, and easy clean, completely tasks so quickly. It includes an integrated circuit controller, with built-in shutdown protection circuit and continuous speed and pulse operating modes. This appliance allows you to break down fruits and vegetables for nutrient-rich juices at home.

## PRODUCT OVERVIEW



### Power Base

The Power Base is the heart of the Nutri Blender 500W. Place one of the Product Cups onto the High-Torque Power Base and press.

Select an operating style by turning the Control dial.

**Caution:** Do not submerge the Power Base in water and always unplug the Power Base before cleaning it.



### Tall Cup and Short Cup

These cups are used to mix, cook and store your ingredients. They are dishwasher-safe (top rack only) and microwave-safe.



### Cross Blade and Flat Blade

The Blender comes with two blades: a Cross Blade for chopping, grating and blending foods such as onions, cheeses, meats and frozen drinks. And a Flat Blade for whipping cream and grinding hard foods like coffee beans and spices. Both blades are dishwasher-safe. In the base of the blades, there is a plastic gasket that creates an airtight fit with the Product cups. After washing a blade, check to make sure the gasket is still inside as the heat from some dishwashers can cause them to become loose.

## HOW TO USE

Using the Nutri Blender 500W is as easy ....

1. Load the ingredients into the Short Cup or Tall Cup.
2. Twist on the Cross Blade or Flat Blade until the blade and cup have a tight seal.
3. Line up the tabs on the cup and with the tabs on the Power base. Press the cup down and gently turn the cup clock-wise until the tabs lock under the lip of the Power base.
4. Select an operating mode by turning the control dial:  
**LEFT (I)** for pulse action, **Right (II)** for continuous speed, central **"O"** for off power.

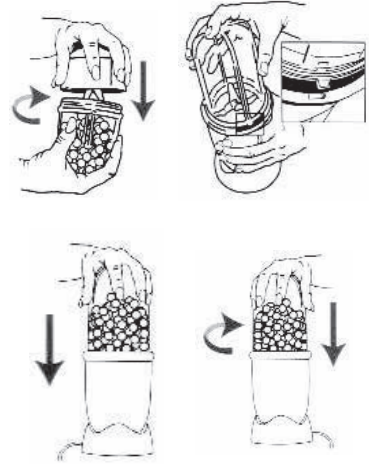

### The Control Dial

O = "OFF" Position

I = Pulse (Meat, Ice cubes, Biscuit, etc.)

II = "ON" Position. Continuously Process (for blending, grinding & chopping)

## CAUTION

- Before using the blade, check the gasket to make sure it is not damaged and it is completely seated in the blade until before each use.
- Never put your hands or utensils near the moving blades and never use your hands or utensils to press the activator buttons down while the Power Base is plugged in.
- If the blade stops spinning while in On (I/II) mode, immediately unplug the Power base. Hard ingredients like carrots or celery can get stuck in the blade and stop it from turning. If this happens, the blade stops, UNPLUG the Blender right away. Remove the blade/cup assembly from the Power Base, and give the ingredients a good shake to unblock the blade. If the blade still remains obstructed, twist off the blade base and carefully spin the metal blades (very sharp) by hand to release blockage. Reattach the blade to the cup, plug in the Power Base and try again. It should be spin normally.
- Never run the machine for more than one minute at a time, as it can cause permanent damage to the motor. If the motor stops working, unplug the Power Base and let it cool for a few hours before attempting to use it again. Your appliance has an internal thermal breaker that shuts the unit off when it overheats. Letting the thermal breaker cool down should allow it to reset.

## Choosing the Right Blade

The **Cross Blade** is used for ... ..

- **Chopping** - Foods like onions, garlic and carrots, and for making dips such as salsa, bean dip, or gazpacho.
- **Blending** – The Cross Blade pulverizes ice for smoothies, frozen cocktails and milkshakes.
- **Mixing** - Batters for pancakes, muffins and quick breads are mixed in seconds.
- **Grating** - Foods like hard and soft cheeses and chocolate are grated in just seconds.
- **Pureeing** - Dishes such as hummus, all-natural soups, and baby food are creamy smooth in seconds.
- **Shaving Ice and Frozen Fruits** - For tasty treats such as snow cones or fruit sorbets.
- **Grinding Meats** - Delicious chicken and ham salads are ground in seconds.

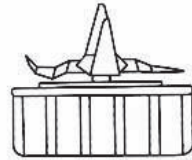

The **straight Flat Blade** is used for ... ..

Grinding and chopping harder, single ingredient items such as:

Coffee beans, Nuts, Cinnamon sticks, Dried fruit.

Or Whipping foods such as:

Homemade whipped cream, Cream cheese schmears and Butter

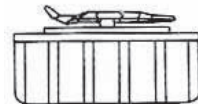

## HOW TO STORE

1. After processing, use water to clean it and use dry cloth to wipe it.
2. Never flush the motor.
3. Assemble the cup with blade and store it far from kids touching.
4. Store it far from UV light and never store it in a wet place.
5. Always unplug the product from mains socket after use.

## FAULT ANALYSIS AND SOLUTION

Failure(s)	Analysis	Solution
Motor not work	Plug not contact to power	Check socket is well and contact completely.
	Cup installed not correct or in place.	Check the cup if installed completely.
	Motor protector in working	Restart after 20-30 mins
Stop working at midway	Too much food in the cup which caused overload or block up then ceased	Decrease the food in the cup and restart
	Long time working, and protected intelligently	Restart after 20-30 mins
Leakage under blade seat	Blade seal broken for blender cup, too much water for bowl.	Turn off the machine and take out the food, check the screw, seal and install again.

❖ If problems persist, contact an approved BALZANO service technician. Always use a certified technician / electrician.

## TECHNICAL DATA

Rated voltage: 220-240V~

Rated frequency: 50/60Hz

Rated wattage: 500W

## ENVIRONMENT FRIENDLY DISPOSAL



Do not throw away the appliance with the normal household waste at the end of its life, but hand it in at an official collection point for recycling. By doing this, you help to preserve the environment.

BALZANO products are intended for household use only

BALZANO has policy of continuous improvement in product quality and design. The company, therefore reserves the right to change the specification of its model at any time.

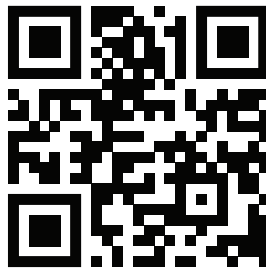

[www.balzano.in](http://www.balzano.in)



[balzano\\_in](https://www.instagram.com/balzano_in)



[Balzano\\_IN](https://www.youtube.com/Balzano_IN)



[BalzanoIN](https://www.facebook.com/BalzanoIN)